

AQUACULTURE AND FORESHORE LICENCE APPLICATION FORM, for purposes of FISHERIES (AMENDMENT) ACT, 1997 and FORESHORE ACT, 1933

NB: The accompanying Guidance Notes should be read before completing this form.

Note: Details provided in Parts 1 and 2 will be made available for public inspection. Details provided in Parts 3 and 4 and any other information supplied will not be released except as may be required by law, including the Freedom of Information Act 1997 as amended.

USE BLOCK CAPITALS IN BLACK INK PLEASE

For Office Use

Application Ref. No. 715/375

Date of Receipt (Dept. Stamp):



Type of Applicant (tick one)	
Sole Trader	<input checked="" type="checkbox"/>
Partnership	<input type="checkbox"/>
Company	<input type="checkbox"/>
Co-Operative	<input type="checkbox"/>
Other	Please specify- <input type="checkbox"/>

PART 1: PRELIMINARY DETAILS

Applicant's Name(s) <u>WILLIAM CASEY</u>
1. Address: <u>CROMANE CROSS, KILLORGLIN, Co. KERRY</u>
2. Address:
3. Address:
4. Address:

Contact in case of enquiries (if different from above)	
Contact Name	
Organisation Name (if applicable)	
Address	

PART 1: PRELIMINARY DETAILS

TYPE OF APPLICATION – please indicate relevant type of application	
This Application Form is valid for each type of application - <i>See Guidance Note 3.1</i>	
(i) Aquaculture Licence	<input checked="" type="checkbox"/>
(ii) Trial Licence	<input type="checkbox"/>
(iii) Foreshore Licence, if Marine Based	<input type="checkbox"/>
(iv) Review of Aquaculture Licence	<input type="checkbox"/>
(v) Renewal of Aquaculture Licence	<input type="checkbox"/>

TYPE OF AQUACULTURE

See Guidance Note 3.2

Indicate the relevant type of application with a tick.

(i) MARINE-BASED

- | | | |
|--|-------------------------------------|--------------------------|
| Finfish | <input type="checkbox"/> | Go to Parts 2.1 and 2.1A |
| Shellfish <i>Subtidal</i> | <input type="checkbox"/> | Go to Parts 2.2 and 2.2A |
| <i>Intertidal</i> | <input checked="" type="checkbox"/> | Go to Parts 2.2 and 2.2A |
| Seaweed/Aquatic Plants/Aquatic Fish Food | <input type="checkbox"/> | Go to Parts 2.3 and 2.3A |

(ii) LAND-BASED

- | | | | | |
|----------------|--------------------------|-------------------|--------------------------|--------------------------|
| Finfish | <input type="checkbox"/> | Shellfish | <input type="checkbox"/> | Go to Parts 2.4 and 2.4A |
| Aquatic Plants | <input type="checkbox"/> | Aquatic Fish Food | <input type="checkbox"/> | Go to Parts 2.4 and 2.4A |

(iii) TRIAL LICENCE

- | | |
|--------------------------|---|
| <input type="checkbox"/> | Go to appropriate Parts as above and to Part 2.5. |
|--------------------------|---|

2.2 MARINE-BASED SHELLFISH AQUACULTURE

When filling out this section refer also to 2.2A and Guidance Note 3.3 for information on Conditions and Documents required with this application type

Proposed Site Location

- (i) Bay: CASTLEMAINE HARBOUR
- (ii) County: KERRY
- (iii) OS Map No: KY056
- (iv) Co-ordinates of Site: (please specify coordinate reference system used e.g. Irish Grid (IG) or Irish Transverse Mercator (ITM) or Latitude/Longitude [in which case specify whether ETRS89 or WG84 etc.]
IRISH GRID -> A: 72680 EASTING 99190 NORTHING.
~~B: 72760 EASTING 99200 NORTHING.~~ C: 73040 EASTING
98400 NORTHING. D: 72700 EASTING 98900 NORTHING. E: 72600
EASTING 99000 NORTHING.
- (v) Size of Site (hectares): 7.6 hectares

(vi) Species (common and scientific name) and whether native or non-native species: (see Guidance Notes 3.3.1)

PACIFIC OYSTER (CRASSOSTREA GIGAS). NON-NATIVE

(vii) Whether production will be sub-tidal or inter-tidal?

INTER-TIDAL

(viii) Please supply details of (a) source of seed e.g. wild hatchery and location and (b) means of collection and introduction to culture. SEED WILL BE SOURCED FROM HATCHERYS IN FRANCE. e.g. FRANCE TURBOT, NOIRMOUTIER,

FRANCE. Also in ENGLAND. e.g. SEASALTER SHELLFISH, KENT, ENGLAND.

NB Importation of seed into the State or movement of seed within the State requires notification to the Marine Institute as per the Fish Health Authorisation Regulations - See Guidance Notes Section 6

(ix) Method of culture (rope, trestles - intensive; bottom - extensive;

other) OYSTER BAGS + TRESTLES - INTENSIVE

(x) Proposed number of lines/ropes/trestles as per site layout drawing

4000 TRESTLES MAXIMUM. REALISTIC NUMBER 2500
IN 8-10 YEARS TIME.

(xi) Proposed Production Tonnage:

Year 1	2 TON	Year 2	4 TON	Year 3	6 TON	Year 4	12 TON	Year 5	12 TON
--------	-------	--------	-------	--------	-------	--------	--------	--------	--------

(xii) (a) Please outline the reasons for site selection:

LOCATED IN INTERTIDAL AREA WITH GOOD RATE OF
WATER FLOW/CHANGE. LITTLE OR NONE HUMAN/WILDLIFE
ACTIVITY IN SURROUNDING AREA. EASE OF ACCESS TO
SITE VIA BOAT.

(b) If using trestles please outline the physical characteristics of the site which make it suitable for using trestles

THE GROUND IS LEVEL + SOLID. THIS WILL MAKE MOVING + POSITIONING THE TRESTLES EASY. THE SOLID GROUND WILL ALSO PREVENT THE TRESTLES FROM SINKING AS THE OYSTERS GROW + GAIN WEIGHT.

(xiii) Is it intended that the product is for direct human consumption or half grown? Please specify

NOT FOR DIRECT HUMAN CONSUMPTION. WILL BE SOLD TO SUPPLIER WITH PURIFICATION FACILITIES.

(xiv) How will the visual impact issues of the flotation devices for the proposed application be addressed? SMALL BUOY'S WILL MARK THE CORNERS OF THE SITE. BUOY'S WILL NOT BE VISABLE FROM LAND UNLESS USING BINOCULARS.

(xv) Is the site located in Designated Shellfish Waters Area? (Refer to Guidance Note 3.3.2)

Yes No

If yes give details.

CASTLEMAINE HARBOUR

If no outline the reasons why you believe the site suitable for the proposed aquaculture, notwithstanding its location outside Designated Shellfish Waters Area?

(xvi) Has the area been classified under Food Safety Legislation? (For Bivalve Molluscs) What is the current classification of the area for the proposed species applied for?

CATEGORY B

(xvii) Is the site located in/adjacent to a sensitive area e.g. SPA (Special Protection Area) or SAC (Special Area of Conservation) i.e. a Natura 2000 site? (Refer to Guidance Note 3.3.1- Natura 2000 sites)

YES

(xviii) Are there known sources of pollution in the vicinity e.g. sewage outfall? Yes / No
If yes please give full details.

NO

(xix) Methods used to harvest the shellfish and details of any subsequent processing of shellfish OYSTERS WILL BE GROWN/HARVESTED + TRANSPORTED TO

SUPPLIER IN OYSTER BAGS. BAGS WILL BE LIFTED OFF TRESTLES BY HAND, PLACED ON A BOAT + BROUGHT TO SHORE FOR FUTHER TRANSPORT

(xx) Describe any proposed purification facilities to be used:

WILL BE SOLD TO SUPPLIER WITH PURIFICATION FACILITIES.

(xxi) What are the main predators of the species to be cultivated?

NO REAL PREDATORS. BIRDS MAY PICK AT YOUNG SEED BUT HAVE VERY LITTLE OVERALL IMPACT.

(xxii) Describe the method(s) which will be used to control them

NONE. OYSTER BAGS KEEP THE OYSTERS RELATIVELY SAFE.

See Part 2.2A for details of documentation to be included with this application type

2.2A DOCUMENTATION REQUIRED FOR MARINE-BASED SHELLFISH AQUACULTURE

(to be included separately with a Licence Application for a new site or for a renewal or review of an existing Licence)

1. **An appropriate Ordnance Survey Map (recommendation is a map to the Scale of 1:10,000/1:10,560, i.e. equivalent to a six inch map). Note: The proposed access route to the site from the public road across tidal foreshore must also be shown on the map.**
2. **Scale drawing of the structures to be used and the layout of the farm.**
The proposed site drawings must illustrate all site structures above and below the water including mooring blocks. (recommended scales normally 1:100 for structures and 1:200 for layout) (See Guidance Note 3.3.2)
3. **The prescribed application fee (See Guidance Note Section 4)**
4. **If the applicant is a limited Company within the meaning of the Companies Act 1963. as amended, the Certificate of Incorporation and Memorandum and Articles of Association**
5. **If the applicant is a Co-operative, the Certificate of Incorporation and Rules of the Co-operative Society**
6. **Environmental Impact Statement (if required) in certain cases- See Guidance Notes Section 3.3.1**
7. **Alien Species dossier (where required) – See Guidance Notes Section 3.3.1**

NOW COMPLETE PARTS 2.6, 3, 4 AND 5 PLEASE

**2.6 Employment, Qualifications, Experience, etc
TO BE FILLED IN BY ALL AQUACULTURE APPLICANTS**

(i) Please provide details of experience/qualifications of the applicant and any key personnel which are relevant to the aquaculture now proposed:

PLEASE SEE ATTACHED MARKED "A"

(ii) If a new application please provide details of projected employment creation during first four years of the proposed aquaculture project:

(iii) In the case of a renewal please provide current and future details:

IN YEAR ONE I WILL NOT REQUIRE ANY EMPLOYEE'S. IN YEAR TWO I WILL NEED ONE TO TWO PART-TIME EMPLOYEE'S. YEAR THREE WILL SEE THIS GROW TO ONE FULLTIME + ONE/TWO PART-TIME, DEPENDING ON TIME OF YEAR. e.g. WHEN OYSTERS ARE READY FOR SALE, EXTRA LABOUR WILL BE NEEDED TO MOVE THEM. BY THE END OF YEAR FOUR I WOULD EXPECT TO HAVE TWO FULLTIME EMPLOYEE'S, WITH AN ADDITIONAL TWO/FOUR PART-TIME, DEPENDING ON TIME OF YEAR.

FULLTIME JOBS

Year 1:	0	Year 2:	0	Year 3:	1	Year 4:	2
---------	---	---------	---	---------	---	---------	---

PART TIME JOBS

Year 1:	0	Year 2:	1-2	Year 3:	1-2	Year 4:	2-4
---------	---	---------	-----	---------	-----	---------	-----

PART 5: DECLARATION AND SIGNING

NB: Refer to Guidance Note Section 3.5 and Section 4 - Guidance on Declaration and Signing and Annual Aquaculture and Foreshore Licence Fees

If this is a renewal/review have you met all licence conditions of the existing aquaculture licence? If applicable, explain why you have not complied with all conditions:

I/We hereby declare the information provided in Parts 1, 2, 3 and 4 above to be true to the best of my/our knowledge. I/We enclose an application fee* of € 95.23 with this application.

Signature(s) of Applicant(s):
(Please state capacity of persons signing on behalf of a Company/Co-op)

Liam Casey

Date: 25-11-2013

NB All persons named on this licence application must sign and date this application form. Only the existing licence holder(s) can apply for the renewal/review of an Aquaculture Licence.

*Preferred method of payment is by cheque or bank draft. The fee should be made payable to the Department of Agriculture, Food and the Marine.

Refer to Guidance Note Section 4 - Guidance on Aquaculture and Foreshore Licence Fees

The application form should be forwarded, with the required documents and application fee, to:

**Aquaculture Licensing
Aquaculture & Foreshore Management Division
Department of Agriculture, Food and the Marine
National Seafood Centre
Clonakilty
Co. Cork**

1 NO. SITE AT CASTLEMAINE HARBOUR CO.KERRY

Co-ordinates & Area

Site T06/375A (7.62 Ha)

The area seaward of the high water mark and enclosed by a line drawn from Irish National Grid Reference point

072680, 099190 to Irish National Grid Reference point
072760, 099200 to Irish National Grid Reference point
073040, 098900 to Irish National Grid Reference point
072700, 098900 to Irish National Grid Reference point
072600, 099000 to the first mentioned point.



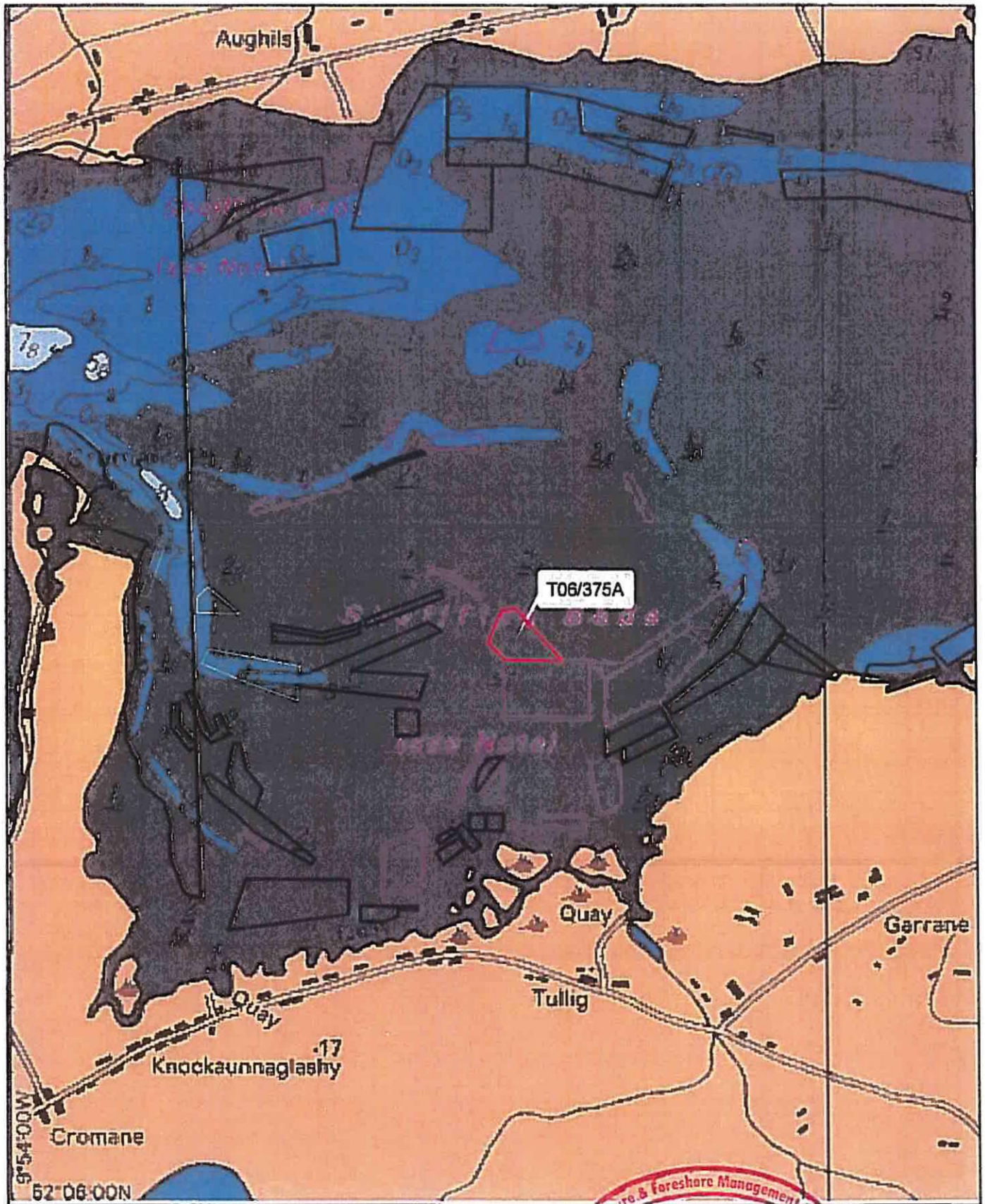

1:30,000

Part of Admiralty Chart No 2789.1

Not to be used for Navigation

Site highlighted in red denotes application.



Aqua Culture Sites	
(all other values)	
Site_Status	
[Red outline]	Application
[Blue outline]	Lapsed
[Green outline]	Licensed
[Yellow outline]	Refused
[Purple outline]	Renewed
[Pink outline]	Revoked
[Grey outline]	Surrendered

Department of
Agriculture,
Food and the Marine
In Gaeilge:
Talmhaíochta,
Bia agus Mara

72000

0

99000

98000

72000

0

TC6/375A

- Aqua Culture Sites**
(all other values)
- Site_Status**
- Application
 - Lapsed
 - Licensed
 - Refused
 - Renewed
 - Revoked
 - Surrendered
 - Withdrawn

1:10,560

Site highlighted in red denotes application.

Ordnance Survey Ireland Licence No. EN 0076413
© Ordnance Survey Ireland/Government of Ireland



Department of
Agriculture, Food and the Marine
An Fóirne
Talmhaíochta,
Bia agus Mara

T6/375.

Ref:	Eastings:	Northings:
A	72680	99190
B	72760	99200
C	73040	98900
D	72700	98900
E	72600	99000

Ref:	Eastings:	Northings:
A	472657.912	599745.551
B	472757.894	599250.548
C	473017.831	598956.612
D	472677.906	598956.613
E	472577.920	599056.591

Proposed fish farm shown outlined in red.
 Licenced Area = 76,167m²
 (7.6Ha)

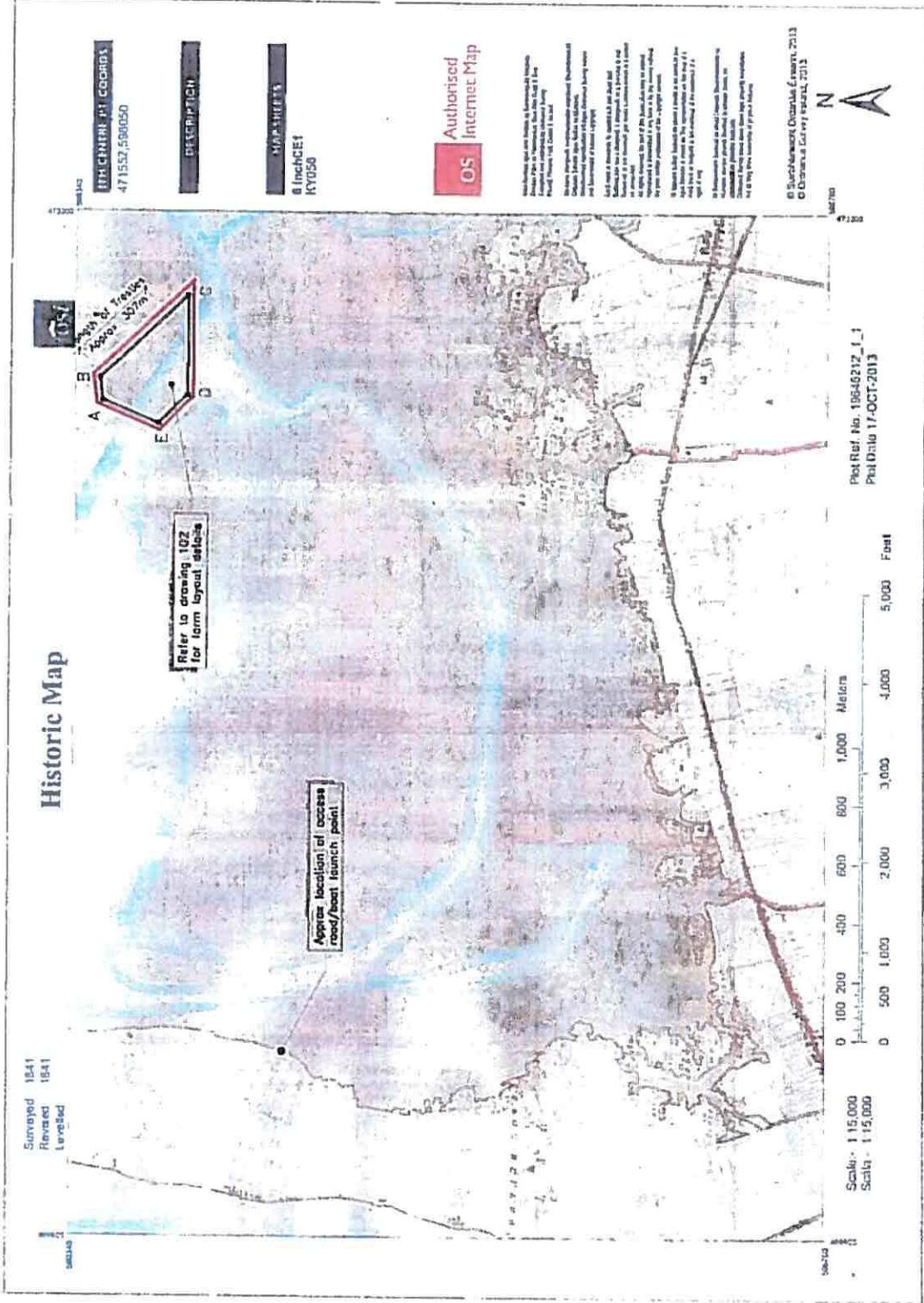

Site Location Plan
 Scale 1:15000

- Notes**
1. This drawing is Copyright Protected
 2. All dimensions are in millimetres, unless noted otherwise.
 3. All levels are in metres and related to Ordnance Datum.
 4. Drawings are not to be scaled.
 5. All dimensions are to be site verified.

Kenny Engineering Services
 11 Querryville,
 Maunabawn,
 Tully,
 Co. Kerry.

Nigel Kenny *Drawn & Engineered*

File No: 1169235
 Mobile: 087 3394218
 E-Mail: nkenny@keneng.com
 www.keneng.com

Drawn By	Checked By	Date	Scale	Sheet No.	Total Sheets
NK	NK	17/10/2013	1:15000	1	1

Project: **Liam Cossey - Oyster Fish Farm Application**
 Castlemaine Harbour

Site Location Plan

Drawn: NK
 Checked: NK
 Date: 17/10/13
 Scale: 1:15000 @ A3
 Sheet No: 13 of 123



OS is a registered trademark of Ordnance Survey. All other trademarks are the property of their respective owners. This map is provided as a service to the public and is not intended for use in navigation. It is not to be used for any purpose other than that for which it was intended. It is not to be used for any purpose other than that for which it was intended. It is not to be used for any purpose other than that for which it was intended.

T6/375

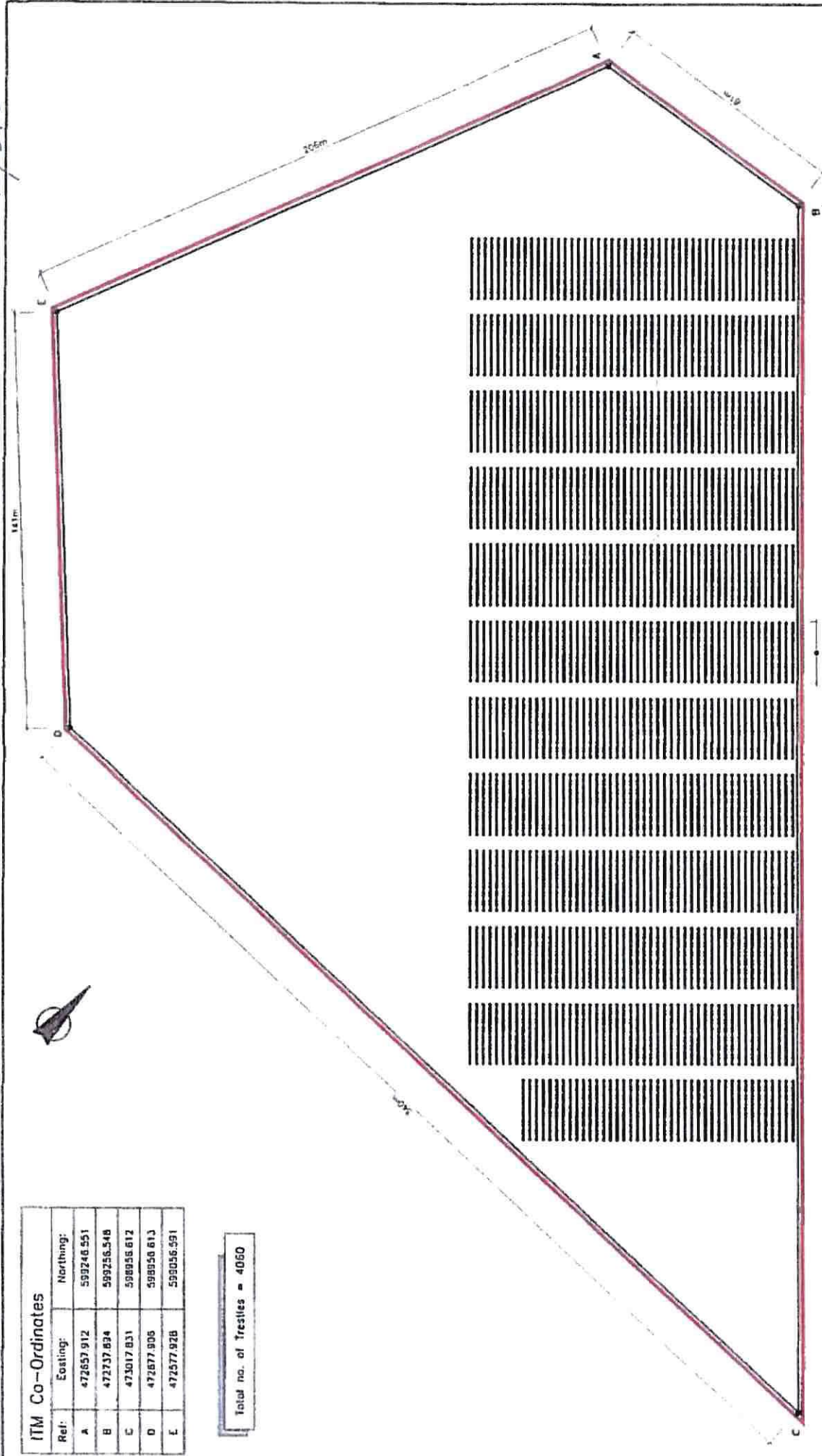

ITM Co-Ordinates		
Ref.	Easting	Northing
A	472657.912	599246.551
B	472737.894	599256.548
C	473017.831	598958.612
D	472877.905	598958.613
E	472577.928	599056.591

Total no. of festiles = 4060

Typical 21m long row of festiles.
See details D1 & D3 on drawing 103.

Pan on Oyster Fish Form
Scale 1:1250

Notes

1. This drawing is Copyright Protected.
2. All dimensions are in millimetres, unless noted otherwise.
3. All levels are in metres and related to Ordnance Datum.
4. Drawings are not to be scaled.
5. All dimensions are to be site verified.
6. Refer to drawing 101 for site location plan.

Project	Liam Cosy - Oyster Fish Form Application Castlemaine Harbour		
Drawing	Plan on Proposed Form		
Drawn by	N.K.	Checked by	N.K.
Date	22/10/13	Scale	1:1250 @ A3
Drawn No.	13-118	Checked No.	13-118-123

Nigel Kenny Chartered Engineer
 11 Quaymore,
 Meath,
 Co. Dub.
 Phone (041) 712323
 Mobile 087 939559
 E-Mail: nkenny@nigelkenny.ie
www.nigelkenny.ie

Drawn	Checked	Scale	Date
N.K.	N.K.	1:1250	22/10/13

T6/375

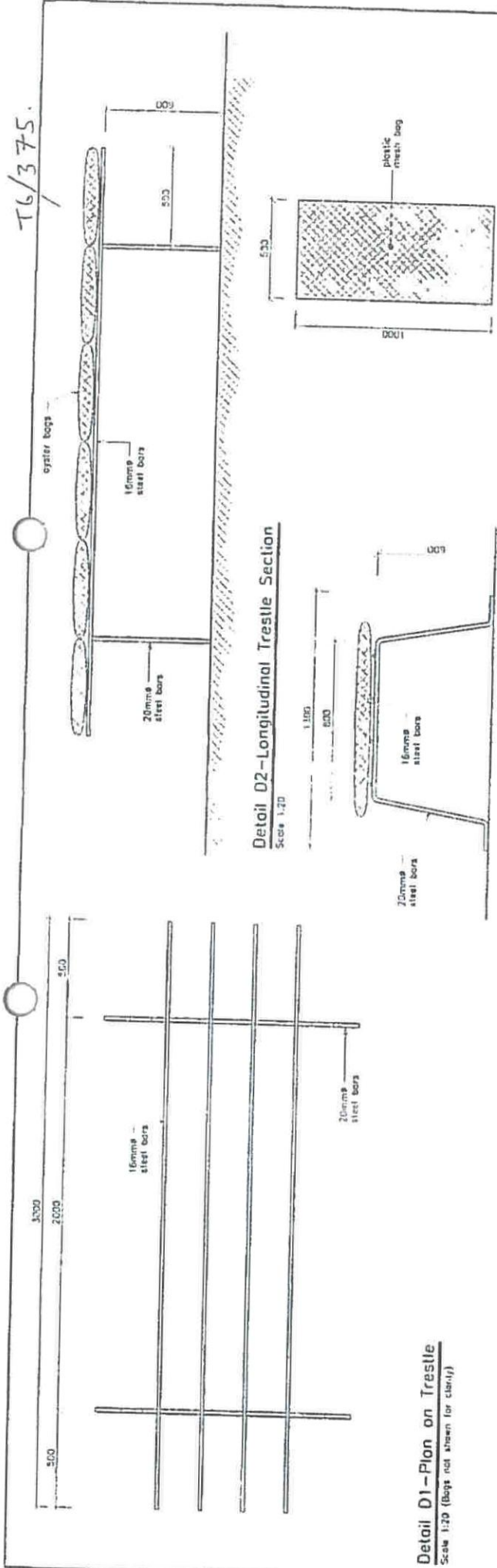

Detail D3 - Typical Oyster Bag
Scale 1:20

Detail D4 - Typical Cross Section
Scale 1:20

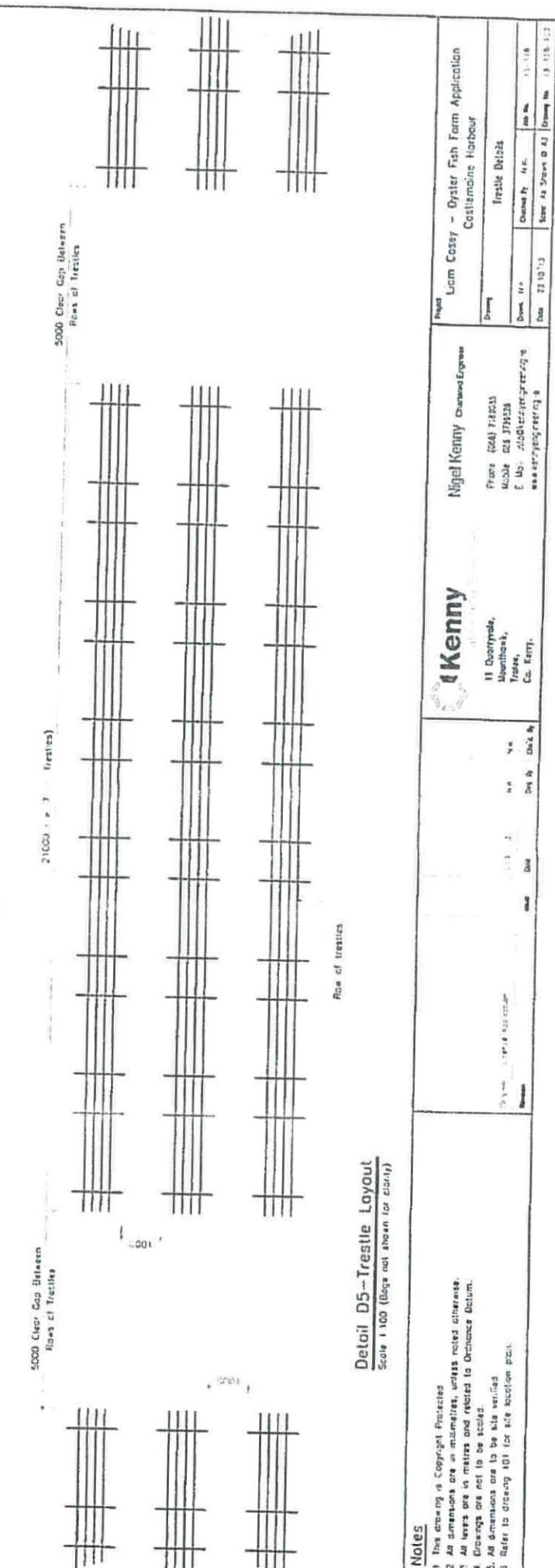

- Notes**
1. This drawing is Copyright Protected
 2. All dimensions are in millimetres, unless noted otherwise.
 3. All levels are in metres and related to Ordnance Datum.
 4. Drawings are not to be scaled.
 5. All dimensions are to be site verified.
 6. Refer to drawing 101 for site location plan.

Kenny
11 Quay Road,
Mounthawk,
Tralee,
Co. Kerry.

Nigel Kenny *Quarry Engineer*
Phone: (044) 748213
Mobile: 084 374218
E-Mail: nkenny@kenny.ie
www.kenny.ie

Project		Liam Cossey - Oyster Fish Farm Application Cottlemine Harbour	
Drawing		Trestle Details	
Drawn by	Checked by	Issue No.	Job No.
Date: 23/10/13	Issue No. 01	Issue No. 01	Job No. 13-118
Drawn by		Issue No. 01	

10

○

○